

PROPOSED PLAN OF G+6 STORIED RESIDENTIAL (APARTMENT) BUILDING (BLOCK A & B) OF SAIMAA SYNERGYONE SOLUTIONS PVT LTS , OVER R.S. PLOT NO. - ~~389,438,443~~ ^{514,515} , L.R. PLOT NO. - 450,451 , L.R KHATIAN NO. - 988, MOUZA - GOPALMATH , J.L. NO - 03 , P.S. - DURGAPUR, DIST- PASCHIM BURDWAN.

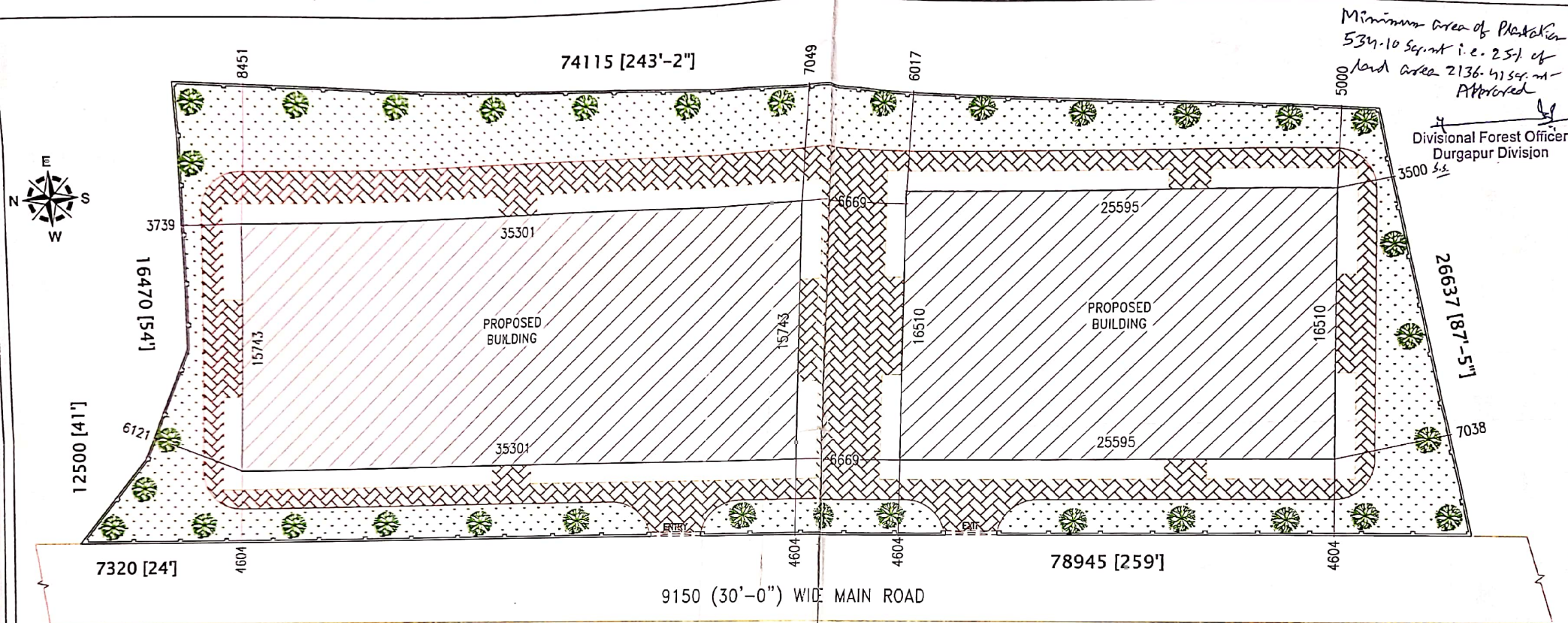

SITE PLAN
SCALE - :100

AREA STATEMENT	NOS. OF TREE TO BE PLANTED	SIGNATURE OF ENGINEER/ARCHITECT	SIG. OF OWNER
1. LAND AREA - 2,136.41 SQ.M.	PLANTATION AREA IS 25% = 534.10 SQ.M.	 VIJAYA SINGH MAZUMDER Consulting Architect DMC Registered [DMC/BPD/60], 9332802166, 9476426106	SAIMAA SYNERGYONE SOLUTIONS PVT. LTD. Authorised Signatory
2. GROUND FLOOR - 978.32 SQ.M.	SAGUN - 7 NOS.		
3. TYPICAL FLOOR - 1,150.13 SQ.M.	DEODHAR - 10 NOS.		
4. TOTAL COVERED AREA (A+B) - 6,728.97 SQ.M. (INCLUDING CAR PARKING)	KRISHNA CHURA - 10 NOS.		
5. FLOOR AREA RATIO - 4,961.00/2,136.41 =2.32	PALM TREE - 6 NOS.		
6. PLANTATION AREA - 534.10 SQ.M.			
7. GROUND COVERED AREA - 53.83 %			
		SCALE.-1:100 OR AS SHOWN	
		DATE.- 02.07.2019	
		SHEET NO. - MN/FOR/BH/F1	